

Air/Water Sequence Valve Service/Conversion Kit P/N 95187

27224 - Same diameter as 27250 but thinner (for vacuum breaker)

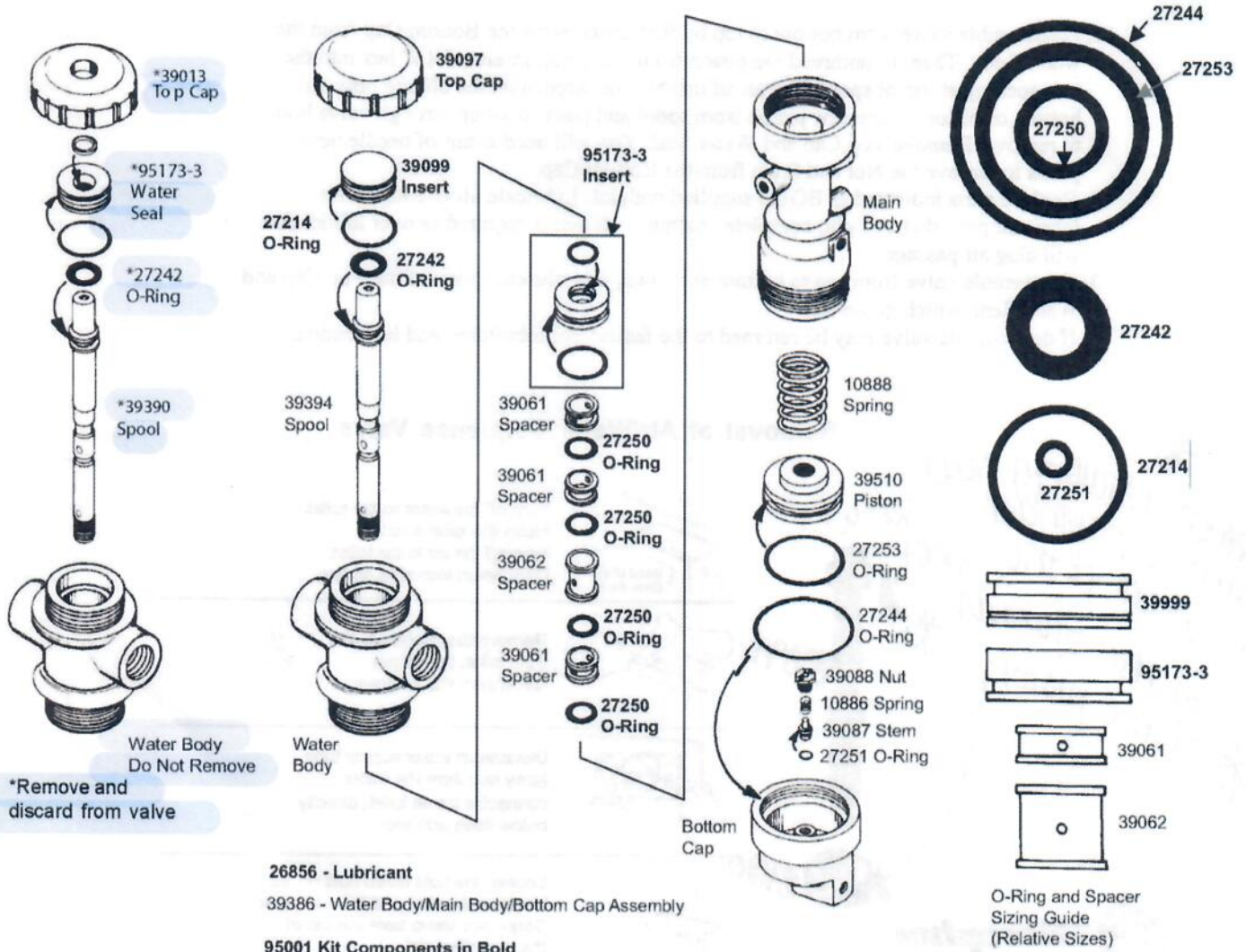

File: 39014

Air/Water Sequence Valve Service Kit

P/N 95187

10886	Spring	1 ea.
24328	Instructions	1 ea.
27214	O-Ring	1 ea.
27244	O-Ring	1 ea.
27251	O-Ring	1 ea.
27224	O-Ring	2 ea.
39087	Stem	1 ea.
39088	Nut	1 ea.
39099	Insert	1 ea.

39394	Spool	1 ea.
10888	Spring	1 ea.
26856	Lubricant	1 ea.
27242	O-Ring	1 ea.
27250	O-Ring	4 ea.
27253	O-Ring	1 ea.
39097	Top Cap	1 ea.
95173-3	Insert	1 ea.
39061	Spacer	3 ea.
39062	Spacer	1 ea.

1. Disassemble valve from bottom to top by first unscrewing the Bottom Cap from the Main Body. Then, to unthread the piston from the spool, insert a 3/16" hex into the hex opening at top of spool. Use an adjustable end wrench on the oblong boss on bottom of piston to unscrew piston from spool and push spool up through valve body to remove. Remove Top Cap and Water Seal. You will need a pair of needle nose pliers to remove the Nut and Stem from the Bottom Cap.
2. Replace parts indicated in BOLD supplied with kit. Lubricate all O-Rings with lubricant provided. A light, complete coating is all that is required as over lubrication will clog air passages.
3. Reassemble valve from top to bottom as shown, with the exception of the Top Cap and Water Seal, which go on last.
4. If desired, this valve may be returned to the factory for rebuilding and lubrication.

Removal of Air/Water Sequence Valve

** When installing new parts, remember to screw the bottom of the spool into the threads of the piston. **



Turn off the water to the toilet.
Flush the toilet twice.
Turn off the air to the toilet.
Disconnect incoming air line.



Remove the flush activator from toilet, but do not disconnect the air lines.



Disconnect water supply tube (grey nut) from the water connector inside toilet, directly below flush activator.



Loosen the hold down nuts on the Vacuum Breaker and the Air/Water Sequence Valve from the top of the mounting plate.



File: Removal of AW

Push Vacuum Breaker and Air/Water Sequence Valve backwards off spud. Loosen, but do not remove the two (2) nuts under the valve bracket. Lift bracket with valves up. Remove water connection. Remove air lines from valve. Separate valve from Vacuum Breaker and remove. Reinstall in reverse order, being careful not to kink air lines. Lubricate and properly seat the new spud o-ring.



Microphor.
A Wabtec company

452 East Hill Road
Willits, CA 95490
Tel: 707.459.5563
Tel: 800.358.8280
Fax: 707.459.6617
www.microphor.com
www.wabtec.com